

Boral Linwood Quarry Community Update

February 2018

The Boral Linwood Quarry is pleased to present this edition of Community Update for the information of our valued neighbours and wider community. As we head into a busy 2018, we want to provide you with an update on our upcoming plans for the beginning of the year.

Update on the Eastern Development

Work on the Mining Proposal for the eastern development is progressing. Our consultants, Groundwork Plus, are undertaking a number of supporting studies to support the lodgement of the mining proposal document.

Flora and fauna surveying on the eastern land was completed in August last year, and hydrology drilling commenced in November. Pegging of the eastern area to secure tenure over the area was also completed in November.

Groundwork Plus is in the process of developing visual imagery of what the eastern development will look like from a number of vantage points around the quarry, including from Hallett Cove and Marino.



The **Conceptual Pit Area** above (blue line) provides an illustration of the conceptual pit extension area to the east of the site. Supporting technical and environmental studies will provide further information regarding the final pit shell to be developed.

As of 12 December 2017, Boral's application for registration of a Mineral Claim (MC) met the requirements of the *Mining Act 1971*, and as a result MC4439 has been registered in the Mining Register.

As part of our Mining Proposal, you may recall that we are required to develop an Exploration Program for Environment Protection and Rehabilitation (EPEPR) for submission to the Department of the Premier and Cabinet (DPC).

The EPEPR is an important document which outlines the initial exploratory activities we wish to undertake within the Mineral Claim area. In it, we are required to advise how we will mitigate any environmental and social disruption to the immediate area and surrounds.

One of the most important activities we wish to undertake is the drilling of 'exploration' and 'seed' holes. This process was detailed within our EPEPR which was lodged at the end of 2017 and has subsequently received DPC approval.

We are now planning the percussion drilling and seed hole blasting activities which we will conduct in February. This testing can only occur with DPC approval of the EPEPR, which is separate to the site's Mine Operation Plan (MOP).

What is seed hole blasting?

We are currently finalising plans for seed hole blasting, which will occur on **Wednesday 14 February**.

Seed holes are used to capture the seismic characteristics of the local geology and assist in determining appropriate blast patterns and sequences to effectively manage the levels of vibration associated with blasting.

This project includes comprehensive planning and design work involving our Drill and Blast Team and a number of external blasting consultants and contractors to ensure accurate data is captured and we minimise disruption to the surrounding community.

To improve the accuracy of the model, up to six (6) geophones (blast vibration and air over pressure monitors) will be used on the site and in the surrounding area to gain sufficient data for input into the blasting vibration model.

The main difference you may notice is the blasting total duration. The seed holes are fired individually with a 2 second delay between each hole. The total duration for all seed holes to be fired may last upwards of 36 seconds for the 18 points.

Understanding what was experienced in late 2016 during a similar exercise, this process will be undertaken with extra guidance and caution by our team. **If you would like to be notified prior to the test blasts occurring, please contact the Linwood Quarry directly on 8296 6230.**

The below Drill Hole Plan pinpoints the exact proposed locations for the seed holes (at 18 points, in black) and geophone monitors (at 6 points, in blue), as stipulated in Boral's EPEPR.

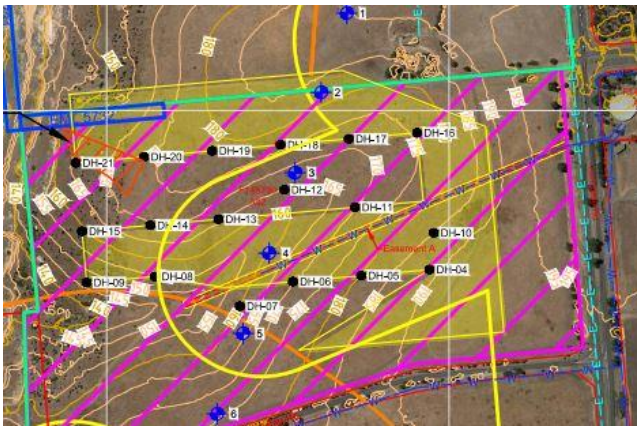

Planned activities for 2018

While 2018 is set to be a busy year for the team as we continue preparing our Mining Proposal, there are also a number of activities we are undertaking on site to improve our operations.

We have now reached the 'dig to' line on the southern wall on our top bench level RL165. We have engaged a contractor to batter the final angle of this bench level as stipulated in the site's risk assessment documentation. This will allow us to start progressively rehabilitating the southern part of the pit.

We are also currently working on a number of continuous improvement projects on site including a focus on dust mitigation. We have a number of additional measures being implemented over the next few months and we will be monitoring these to determine their effectiveness.

What you told us (so far...)

The team at Linwood would like to thank those who attended our community-drop in sessions which were held in September 2017.

With more than 40 people coming along to the Cove Civic Centre, these sessions were an invaluable opportunity to gain your thoughts and ideas on what

you would like to see as part of the Linwood Quarry Eastern Development proposal.

We were able to gain further insight and more detail about aspects of our proposal, and allowed us to capture a wide variety of viewpoints and opinions.

Some of the feedback we received included:

- Further vegetation planting along the southern boundary
- Planting of native vegetation
- Ongoing management of vegetation by Boral
- Flexibility in blasting dates and times
- Improvements to the Perry Barr Road look-out for increased parking and accessibility.

This feedback was incredibly valuable and has already influenced the Mining Proposal, especially in regards to the planting of native vegetation to assist in screening our operations.

As the Mining Proposal process progresses, we will hold further drop-in sessions to ensure you are aware of our plans and to give you an opportunity to provide us with additional feedback.

Our next sessions will include a number of visual concept drawings which will show what the eastern development will look like over time from various vantage points in the community.

Road relocation update

The process to relocate the Linwood Quarry access road from Clubhouse Road is well underway, with the Majors Road intersection selected as the preferred option.

Consultants have been engaged to deliver a Department of Planning Transport and Infrastructure (DPTI) approved design for the haul road and the Majors Road intersection.

An initial 'in principle' design has been tested and adjusted, and is now with DPTI for further approvals.

Time frames are subject to regulatory approvals, however, the intention is to have works completed by the end of 2018.

Contact us

We welcome your comments and feedback about any topic relating to the Linwood Quarry and the Eastern Extension Project.

Phone us: 8296 6230 (Linwood Quarry); (03) 9981 2925 (Stakeholder Relations Advisor)

Email us: feedback@boral.com.au

Visit our websites: www.boral.com.au/feedback
www.boral.com.au/linwoodquarry