

# Partiwall®

## INSTALLATION NOTES

PB202 NOVEMBER 2010

To be used in conjunction with information on [www.boral.com.au/partiwall](http://www.boral.com.au/partiwall)

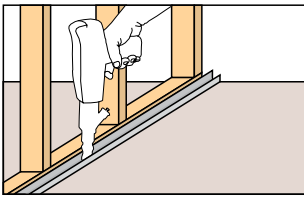

### Step 1: Fixing bottom track

- Position track at the base level centred in the Partiwall® cavity and attach to foundation with power actuated fasteners at both ends and at 600mm maximum spacing.
- Use full lengths spaced 6mm apart and 20-40mm from the frame.
- Start and end nominal 40mm from inside of external brickwork or level with inside face of cladding material.
- Apply acoustic sealant along track/floor junction on one side. Refer to step 7.

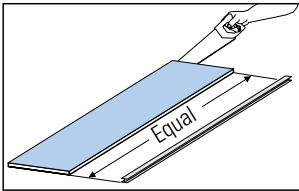

### Step 2: Cut Shaftliner™ panels and Partiwall® stud to the same length

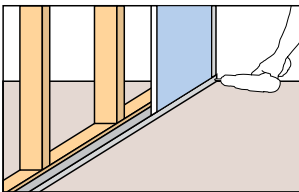

### Step 3: First Shaftliner™ panel fitted into base track

- To enable later fixing of aluminium clips, cut this Shaftliner™ panel to width so that its edge falls at least 50mm from a wall frame stud.
- House the outside edge at the end of the wall with the track.
- Screw this end track to the base track where they meet.

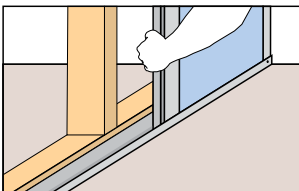

### Step 4: First Partiwall® stud fits fully down into track

- Move it along the track to house the edge of the Shaftliner™.
- Lightly tap up to give a snug fit.
- Fit the second Shaftliner™ panel.
- Fix H-stud to timber frame with Partiwall® aluminium clip.

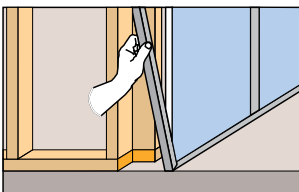

### Step 5: Continue fitting Partiwall® studs and Shaftliner™ panels

- House last Shaftliner™ panel with track at the end of the wall.
- Exposed Shaftliner™ barrier, may be subjected to high wind forces and so must be adequately braced while exposed to the wind.
- Continue to erect Partiwall® studs and Shaftliner™ panels progressively until the fire barrier is completed.

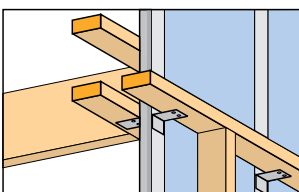

### Step 6: Aluminium Partiwall® clips fasten all Partiwall® studs to wall frame

- Must be at every Partiwall® stud.
- Maximum 3000mm apart vertically.
- For aligned floors, must be directly opposite on both sides of the Partiwall® studs. Alternatively, Partiwall® clips can be staggered in line with offset floors.
- Where Shaftliner™ panels butt to external wall, cap the vertical edge of panels with Partiwall® track screw fixed to base track with 10g x 16mm drill point wafer head screws.

## Installation of Shaftliner™ Fire Barrier

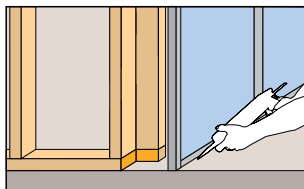

### Step 7: Seal for acoustics and fire

- Provide continuous Partiwall® batts at wall ends and roof as specified.
- Seal bottom track with a recommended fire rated acoustic sealant.

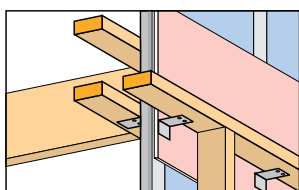

### Step 8: At mid-floor

- Cut and screw laminate 16mm Firestop® plasterboard to one side ensuring minimum 150mm overlap above floor and below ceiling level.
- It is recommended the gap from Partiwall® panel to wall stud framing be increased to a minimum of 25mm on this side to ensure adequate clearance for the Firestop® plasterboard.
- Screw laminate one layer of 16mm Boral Firestop® plasterboard to one side of Shaftliner™ fire barrier as required. Fasten at maximum 400mm x 400mm centres with 10g x 40mm Type 'L' laminating screws minimum 10mm from edge of the board.
- Fix clips to Partiwall® studs with 2 x 10g x 16mm 'D' type screws.
- Fix clips to timber plates with 2 x 2mm dia x 25mm nails or 2 x 6g x 25mm 'W' type screws.
- Fix clips through 16mm Firestop® to Partiwall® studs with 2 x 10g x 30mm 'D' type screws.
- As framing progresses, clip Partiwall® studs to wall plates on the other side.

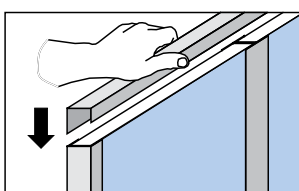

### Step 9: Cap top of Shaftliner™ panels and Partiwall® studs with track

- Use full lengths, end to end, spaced 6mm apart.
- Houses top of Partiwall® studs, end tracks and Shaftliner™ panels.
- Screw this capping track to the end tracks where they meet.

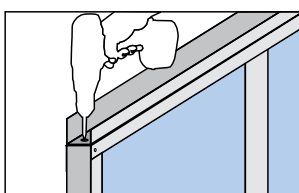

### Step 10: Upper sections

- Back capping track with base track.
- Fasten with minimum 10g x 16mm screws at 600mm centres.
- Cut Shaftliner™ panels and Partiwall® studs, cut to a length not exceeding 600mm above clip support points.
- Install as previously Partiwall® studs to align vertically with bottom section.

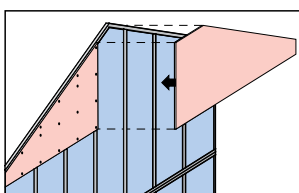

### Step 11: At roof

- Measure and cut Shaftliner™ panels and Partiwall® studs to pitch of roof.
- Cap on rake and clip Partiwall® studs to roof frame on one side.
- Cut and screw laminate 16mm Firestop® plasterboard to one side of Shaftliner™ fire barrier in the roof space with 10g x 40mm Type 'L' laminating screws at 400mm x 400mm centres, minimum 10mm from edge of Firestop®.
- Fix Partiwall® clips to Partiwall® studs through 16mm Firestop® plasterboard with 10g x 30mm Type 'D' drill point screws and to framing.
- Provide nominal 25mm gap between top end of Shaftliner™ fire barrier and roofing.

## Do's and Don'ts

- **Do** use aluminium clips at every Partiwall® stud and not more than 3000mm above lower clip line or base track.
- **Do** locate and fix down bottom track adequately.
- **Do** seal at bottom track.
- **Do** install Partiwall® batts at wall ends and top, as specified.
- **Do** cut Partiwall® stud and Shaftliner™ panels to the same length.
- **Do** insert Partiwall® stud and Shaftliner™ fully into the base track.
- **Do** insert Shaftliner™ panels fully into the Partiwall® studs.
- **Do** use the specified fasteners for aluminium Partiwall® clips.
- **Don't** use damaged materials.
- **Don't** penetrate the Shaftliner™ other than in the roof space as per Boral's details.
- **Don't** exceed specified clip spacing.
- **Don't** use steel clips.
- **Don't** cut tracks between Partiwall® studs. Tracks should be used in full lengths.
- **Don't** run services in the gap between Shaftliner™ fire barrier and framework.
- **Don't** use Partiwall® H-stud in lieu of Partiwall® track as edge capping nor as horizontal joint in Shaftwall™ fire barrier.

## Technical Enquiries

### TecASSIST

**1800 811 222**

F: (03) 9214 2192

E: [tecassist@boral.com.au](mailto:tecassist@boral.com.au)

TecASSIST provides technical advice to builders, architects, contractors, engineers, regulators and home owners throughout Australia.

Our friendly team can offer both practical and design input at all levels of the plasterboard industry.

Get your next project off on the right track by giving TecASSIST a call weekdays 8.30am - 4.30pm AEST.

## Sales Enquiries

**1800 003 377**

<b>ACT</b>	7 Barrier Street, Fyshwick 2609	F: (02) 6280 5816
<b>New South Wales</b>	3 Thackeray Street, Camellia 2142	F: (02) 9638 5557
<b>Northern Territory</b>	Coonawarra Road, Winnellie 0820	F: (08) 8984 3778
<b>Queensland</b>	22 Kirra Street, Pinkenba 4008	F: (07) 3115 7321
<b>South Australia</b>	39 Burleigh Avenue, Woodville North 5012	F: (08) 7002 6381
<b>Tasmania</b>	93 Albert Road, Moonah 7009	F: (03) 6278 9865
<b>Victoria</b>	251 Salmon Street, Port Melbourne 3207	F: (03) 9214 2192
<b>Western Australia</b>	41 Rudderham Drive, North Fremantle 6159	F: (08) 6226 9833
<b>Export Department</b>	251 Salmon Street, Port Melbourne 3207	F: (03) 9214 2192 T: (03) 9214 2121 E: <a href="mailto:tecexport@boral.com.au">tecexport@boral.com.au</a>

## [www.boral.com.au/partiwall](http://www.boral.com.au/partiwall)

Partiwall®, Firestop®, Soundstop® and ENVIRO® are Registered Trade Marks of Boral Australian Gypsum.

Shaftliner™ is a Trade Mark of Boral Australian Gypsum.

Villaboard® is a Registered Trade Mark of James Hardie Australia Pty Ltd.

FireSound® is a Registered Trade Mark of HB Fuller Australia Pty Ltd.

Tyvek® HomeWrap® is a registered trademark of E.I. duPont de Nemours and Company or related companies.

© Copyright Boral Limited 2010

The technical information contained in this manual was correct at the time of printing.

Building systems and details are, however, subject to change.

To ensure the information you are using is current, Boral recommends you review the latest building information available on the Boral website.

For further information contact TecASSIST® or your nearest Boral Plasterboard Sales Office.

